

# STRENGTHENING COMMUNITY CARE AND INCLUSIVE EDUCATION FOR CHILDREN WITH DISABILITIES IN GEORGIA



UNICEF/Geo-2014/Khizanishvili

## Progress Report of UNICEF Georgia to the Government of the Republic of Bulgaria (23 December 2016 – 30 June 2017)

For every child  
Health, Education, Equality, Protection  
ADVANCE HUMANITY

unicef 

## TABLE OF CONTENTS

<b>PROJECT SUMMARY .....</b>	<b>3</b>
<b>I. BACKGROUND.....</b>	<b>4</b>
<b>II. ESTABLISHMENT OF QUALITY SERVICES FOR CHILDREN WITH DISABILITY – ‘A MODEL AS A BEST PRACTICE’ .....</b>	<b>5</b>
<b>III. CAPACITY DEVELOPMENT .....</b>	<b>5</b>
<b>IV. TECHNICAL SUPPORT, OVERSIGHT AND ACCOUNTABILITY.....</b>	<b>6</b>
<b>V. OPPORTUNITIES AND CHALLENGES.....</b>	<b>7</b>
<b>VI. OUTLOOK ON NEXT STEPS .....</b>	<b>7</b>
<b>VII. PROJECT MANAGEMENT .....</b>	<b>8</b>
<b>VIII. APPRECIATION OF SUPPORT.....</b>	<b>8</b>
<b>IX. DONOR STATEMENT BY NATURE OF EXPENSE.....</b>	<b>9</b>
<b>ANNEX 1: GOVERNMENT DECREE ON THE TRANSFER OF THE PROPERTY TO TRC .....</b>	<b>10</b>
<b>ANNEX 2: CONTRACT OF PROPERTY TRANSFER BETWEEN NASP AND TRC .....</b>	<b>11</b>
<b>ANNEX 3: RECONSTRUCTION PLAN OF THE BUILDING.....</b>	<b>12</b>
<b>ANNEX 4: TRAINING CURRICULUM.....</b>	<b>13</b>

## LIST OF ACRONYMS

CWD – Children with Disabilities

DCC – Day Care Centre

LA – Local Authorities

MAC – McLain Association for Children, NGO

MoESD – Ministry of Economy and Sustainable Development

MoLHSA – Ministry of Labour, Health and Social Affairs

NASP - National Agency of State Property Management

NNC – Bulgarian National Network for Children

PDO – Public Defender’s Office

PPP - Public-Private Partnerships

SSA – Social Service Agency

TRC – Together for Reach Changes, NGO

UNCRPD – UN Convention on the Rights of Persons with Disabilities

## PROJECT SUMMARY

<b>Country</b>	Georgia
<b>Name of Intervention</b>	Strengthening community care and inclusive education for children with disabilities in Georgia
<b>Donor</b>	Government of the Republic of Bulgaria
<b>Contribution Reference</b>	SC160649
<b>Total contribution</b>	99,107.58 USD
<b>Programmable</b>	94,388.17 USD
<b>Total Funds used to date</b>	43,398.04 USD
<b>Unspent Balance</b>	55,709.54 USD
<b>Duration of Grant</b>	23 December 2016 – 22 December 2017
<b>Report Type</b>	Progress report
<b>Reporting period</b>	23 December 2016 – 30 June 2017
<b>Report Due Date</b>	30 June 2017
<b>UNICEF Strategic Plan 2014-2017 Outcome Area</b>	Child Protection - Improved and equitable prevention of and response to violence, abuse, exploitation and neglect of children
<b>Geographic Focus area</b>	Samtskhe-Javakheti Region, Georgia
<b>Focus Population</b>	Children with Disabilities, their parents and caregivers
<b>Programme Partners</b>	MoLHSA
<b>UNICEF Contact(s)</b>	1) Representative, Dr. Laila Omar Gad, <a href="mailto:logad@unicef.org">logad@unicef.org</a> 2) Chief Child Protection, Mr. Pierre Ferry, <a href="mailto:pferry@unicef.org">pferry@unicef.org</a> 3)
<b>Bulgarian Government / Embassy Contact (s)</b>	1) Ambassador of the Republic of Bulgaria in Georgia, H.E. Dessislava Ivanova, <a href="mailto:dessislava.IVANOVA@mfa.bg">dessislava.IVANOVA@mfa.bg</a> 2) Second Secretary at the Embassy of the Republic of Bulgaria in Georgia, Dr. Christiana Christova, <a href="mailto:christiana.christova@mfa.bg">christiana.christova@mfa.bg</a>

## I. BACKGROUND

Since 2005 the Government of Georgia, with the support of UNICEF, has been conducting a reform of the childcare system which significantly reduced the number of children in large-scale State institutions from 4,100 in 2005 to 85 in 2015<sup>1</sup>. Nevertheless, concerns remain regarding the continued use of institutions for Children with Disabilities (CWD). Additionally, significant disparities still exist between urban and rural areas as regards to access to services for CWD. Data related to CWD is not accurate and consistently underestimated. In 2017, 8,973 children<sup>2</sup> (1.2% of child population) are registered as CWD. A significant number of CWD therefore remain invisible and their well-being, inclusion and development are at risk. The existing stigma against CWD<sup>3</sup>, limited access to services and flaws of the status determination system contribute to the inaccuracy of the official data. The access to services remains a challenge, as services for CWD exist only in few major cities. UNICEF has stressed the issue and negotiated with MoLHSA to expand funding of the state program for CWD to those regions without services.

In the framework of UNICEF support to the Government of Georgia to reform and improve national standards and services for children with disability, the current project supported by Bulgarian Ministry of Foreign Affairs and the Bulgarian Embassy in Georgia, aims at developing a community-based model as a best practice and at increasing access to quality services for CWD in Samtskhe-Javakheti region.

The proposed community centre will provide families of CWD with relevant skills and knowledge to better care for their children. The project is also intended to contribute to strengthening the child welfare system through proposing quality standards of care that will be duplicated in other State supported centres throughout Georgia. UNICEF's involvement in the initiative will contribute to promoting equity, gender equality, child rights based approach in programming and to improved access to services for CWD. UNICEF will provide technical assistance to MoLHSA in revising standards of day care services.

During the period covered by the present report, the National Agency of State Property Management (NASP) has transferred a building to the local NGO "Together for Real Change" (TRC) which will host and administrate the centre. The implementing partner "The McLain Association for Children" (MAC), together with TRC, has developed detailed plans for reconstruction and equipping of the centre.

MAC has issued call for tender for the reconstruction of the day care centre for CWD and has developed a detailed recruitment and training plan for the staff of the centre.

TRC has started recruitment of the staff.

---

<sup>1</sup> Ministry of Labour, Health and Social Affairs of Georgia, Social Services Agency

<sup>2</sup> Social Service Agency, Statistics on the Beneficiaries of the Social Package by Types and Age Groups, available at [www.ssa.gov.ge](http://www.ssa.gov.ge)

<sup>3</sup> Social Service Agency, Statistics on the Beneficiaries of the Social Package by Types and Age Groups, available at [www.ssa.gov.ge](http://www.ssa.gov.ge)

## **II. ESTABLISHMENT OF QUALITY SERVICES FOR CHILDREN WITH DISABILITY – ‘A MODEL AS A BEST PRACTICE’**

UNICEF is facilitating the establishment of a quality service in Borjomi, to support the full development of potential of children with disabilities, to end their isolation, and to support their social inclusion.

UNICEF team together with the local NGOs MAC and TRC have identified a suitable building to host the day care centre for CWD. During the inception phase, UNICEF and its partners have conducted a series of meetings with local authorities of Borjomi municipality, with parents of children with disabilities and with the line ministries (MoLHSA and MoESD).

TRC, with support of local government and NAS, has facilitated the process of registration of the building at the State registry. UNICEF has worked closely with MoLHSA, MoESD and NASP to facilitate the conditional transfer of the State property to TRC for the establishment of the day care centre for CWD. The requirements of the conditional transfer will ensure the sustainability of the function of the building as the service for CWD. NASP has drafted a relevant decree for the government’s review. The Prime Minister has approved the decree during the government session on 23 March 2017 (Annex 1). The decree defined the conditions of the transfer and ordered NASP to issue a contract for realization of this transfer for 20 years with the possibility of further extension. NASP issued the contract with TRC on 11<sup>th</sup> May 2017 (Annex 2).

MAC and TRC together with the team of architects and engineers have designed a reconstruction plan for the model as a best practice for CWD. The designed architectural plan (Annex 3) for reconstruction ensures that the access to the building and interior is fully adapted for children with special needs. The team of architects has also prepared a detailed list of the reconstruction works and a cost estimation. MAC has announced a tender for the procurement of the services in order to select the company that will be reconstructing the building.

Finally, MAC and TRC have prepared a detailed list and specifications of the equipment for the centre. MAC will procure the equipment through an open bidding focusing on the quality and the cost of materials.

## **III. CAPACITY DEVELOPMENT**

A well-equipped facility must be staffed with well-trained and dedicated professionals. The capacities of professionals working with CWD is critical for achieving the best possible results. MAC is a qualified local NGO experienced in training and building capacities of the staff working with children with disabilities. MAC has developed a detailed capacity-building plan.

Based on the current state childcare standards any training curricula designed for the staff of childcare services should be agreed with MoLHSA. Therefore, MAC has submitted the curricula (Annex 4) to MoLHSA for their review and approval.

UNICEF will support MoLHSA in refining state standards for day care centres for CWD, based on the best practices of the current project. UNICEF’s technical assistance remains vital for promoting social inclusion, equity and the development of the state-run child-friendly services free from all forms of discrimination.

As the focus on capacity development extends beyond the gates of the centre, MAC has also designed curricula for statutory social workers and representatives of educational resource centres, local authorities and regional offices of PDO.

It is indeed critical to support the local authorities in establishing a strong referral system between healthcare professionals, statutory social workers, school and kindergarten staff. Building this referral system is essential for ensuring non-discrimination, equity and the enrolment of CWD in all relevant local services. UNICEF’s extensive experience of cooperation with central and local government in Georgia will contribute to building a sustainable and efficient cooperation between the State agencies and NGOs working for CWD.

MAC has developed a detailed recruitment plan, along with job descriptions of the day care centre staff. MAC and TRC have advertised positions in the beginning of June. The vacancies were announced on the most referred website [www.jobs.ge](http://www.jobs.ge). In parallel, MAC has placed advertisement on the state-run recruitment website<sup>4</sup> used for vacancies in social sphere. The advertisement was also publicised on the Borjomi TV and the local newspaper.

TRC has started recruitment of following staff:

Position:	Available positions in DCC	# of Received applications
Manager of the day care centre service	1	16
Special teachers	6	12
Psychologist	1	5
Speech therapist	1	1
Cook	1	3
Nurse	1	2

After the initial review of the applications and interviews MAC and TRC have selected total of 16 candidates for the training.

MAC and TRC will conduct the final selection of the staff based on the result of post-test following the completion of the trainings.

#### **IV. TECHNICAL SUPPORT, OVERSIGHT AND ACCOUNTABILITY**

The systems and services for CWD in Georgia are currently under-developed. The Bulgarian National Network for Children (NNC) will be sharing its expertise with Georgian actors in the framework of this

---

<sup>4</sup> [www.worknet.gov.ge](http://www.worknet.gov.ge)

project. UNICEF has therefore established contacts with George Bogdanov, the head of NNC. The latter proposed one of its member organization “Friends of Karin Dom’ Association”<sup>5</sup> to be involved with the implementation of the project.

“Friends of Karin Dom Association” are well known specialists working with children with disabilities and their families. They are part of NNC and have very experience in training, coaching on yearly intervention. The NGO is also social service provider, which runs day care centre in Varna.

Consequently, MAC has established contact with the specialists of “Friends of Karin Dom” and invited them to conduct a week visit to share their experience with Georgian civil society organizations working in the field of disabilities and with relevant State authorities.

## V. OPPORTUNITIES AND CHALLENGES

TRC is closely working with the local authorities and with the business community to mobilize external resources to ensure better functioning of the day care centre. TRC has discussed with the Governor of Borjomi a plan to support transportation of beneficiaries from surrounding Tsagveri village to the DCC. Local company Borjomi Waters was approached by TRC for co-funding utility costs of the DCC. The negotiations are on-going, but Public Private Partnership can generate funds for additional developmental equipment and for covering ongoing utility costs.

During the reporting period, the main challenge was the delay in government’s decision to transfer the building to TRC. It is to be noted, that the process of the conditional transfer of the property to the local NGO took more time than initially expected because of involvement of many different state agencies and their slow operation. This delay has postponed the starting of the reconstruction works. To correct the course and mitigate the risks related to the delay UNICEF and partners have revised project timeframe and amended schedule. The modifications included speeding up parallel process of reconstruction and trainings. Registration of the DCC is a time-consuming process, involving MoLHSA’s monitoring units’ visits to the centre for its evaluation. UNICEF and partners negotiated with MoLHSA to ensure early involvement of the monitoring unit in the assessment of the environment of the DCC. MoLHSA has agreed to speed up the evaluation process and as a result initial visit of the monitoring unit was conducted in June 2017.

## VI. OUTLOOK ON NEXT STEPS

The next immediate project steps in the upcoming reporting period are as follow:

- Finalization of the reconstruction. The joint board comprised of MAC, TRC and UNICEF will review the tender applications from the construction companies. The board will select the company based on the provided quality and price estimation. The selected company will start reconstruction in July 2017 and it is expected to complete the process in September 2017.

---

<sup>5</sup> <https://karindom.org/en/our-mission/>



- Completion of the training, selection and supervision of the staff of the day care centre. The Trainings and final selection of staff will be finalized in August 2017. The staff will start working at the end of September. MAC will start supervision of DCC staff in October 2017.
- Opening of the centre. MAC and TRC will organize the process of equipping of the centre with relevant furniture and developmental materials in parallel with the reconstruction. It is expected that the Centre will be fully equipped and reconstructed towards the end of September 2017.
- Conducting trainings for local authorities and local statutory specialists. MAC and TRC will initiate discussions with LAs on the identification of specialists responsible for social programs. The workshops will be offered to local statutory specialists including social workers, specialists of city councils, educational resource centres and local policlinics.
- Sharing Bulgarian experience and best practices with local specialists in October - November 2017. MAC and “Friends of Karin Dom Association” will finalize the date for the visit in July. It is expected that a week-long visit will be held with Bulgarian specialists to meet with government and NGO actors to share the best practice experiences and conduct supervision of the daily work of Borjomi DCC staff.
- Based on the developed model as a best practice, UNICEF will provide technical assistance to MoLHSA in revising standards of services. UNICEF’s technical support to the government agencies will also contribute in the improvement of statutory monitoring of the child care services.

## VII. PROJECT MANAGEMENT

Under the leadership of UNICEF Georgia’s senior management, the child protection section ensured project oversight and monitoring. This assured the appropriate management milestones were managed and completed. UNICEF provided the technical support and facilitated the exchange as well as effective communication among all parties concerned.

## VIII. APPRECIATION OF SUPPORT

### APPRECIATION OF SUPPORT

**UNICEF Georgia wishes to express its thanks to the Government of the Republic of Bulgaria for its generous contribution to the strengthening of community care and inclusive education for children with disabilities in Georgia. We are looking forward to our continued cooperation to jointly address challenges and embark on opportunities in the**

## IX. DONOR STATEMENT BY NATURE OF EXPENSE

### UNITED NATIONS CHILDREN'S FUND (UNICEF)



OTHER RESOURCES CONTRIBUTION RECEIVED FROM: BULGARIA

DONOR STATEMENT BY NATURE OF EXPENSE (UNCERTIFIED) FROM 23 DECEMBER 2016 TO 30 JUNE 2017 IN US DOLLARS

#### Status of Contribution

External Reference:			
Description:	Georgia: To Strengthen Community Care and Inclusive Education for Children		
Contribution Reference:	SC160649		
Effective Date:	23.12.2016		
Expiry Date:	22.12.2017		
Recipient Office(s):	Georgia		
Agreement Currency:	EUR		
Agreement Amount:	EUR	93,359.34	
Funds Received:	EUR	93,359.34	
Refunds:	EUR	0.00	
Funds Receivable:	EUR	0.00	

#### Summary of Expenditures (USD)

<u>Description</u>	<u>Cumulative Expenditure</u>
Programmable Expenditure:	41,331.47
Indirect support cost 5%	2,066.57
<b>Total:</b>	<b>43,398.04</b>
Funds Received in USD:	99,107.58
Unspent Balance:	<u>55,709.54</u>

#### Details of Expenditures (Georgia)

Description	Incurred Expense		Cash Advances and Prepayments	Cumulative Expenditure	Commitments*
	2016	2017			
Contractual Services	0.00	246.45	0.00	246.45	0.00
Travel	0.00	826.26	0.00	826.26	0.00
Transfers and Grants to Counterparts	0.00	0.00	40,258.77	40,258.77	0.00
General Operating + Other Direct Costs	0.00	(0.01)	0.00	(0.01)	0.00
<b>Total Programmable Cost</b>	<b>0.00</b>	<b>1,072.70</b>	<b>40,258.77</b>	<b>41,331.47</b>	<b>0.00</b>
Indirect support cost 5%	0.00	53.64	2,012.94	2,066.57	
<b>Total</b>	<b>0.00</b>	<b>1,126.34</b>	<b>42,271.71</b>	<b>43,398.04</b>	

\* "Commitments" include undelivered purchase orders, payment commitments for implementing partners and travel advances approved but not yet paid. The amounts shown in this column represent the status and value of the commitment as at the date the report is produced. As goods are received and commitments in respect of implementing partners and travel advances are paid these amounts will be added to "incurred expense".

Amounts in this report are provisional. Official amounts are provided in the Certified Statement of Account.

Note: This report contains data as of refreshed date 20.06.2017

Report Generated On: 22.06.2017 3:01 AM

სს ქ-ბ



**საქართველოს მთავრობის  
განკარგულება**

№558 2017 წლის 23 მარტი ქ. თბილისი

ა(ა)იპ - ერთად რეალური ცვლილებებისათვის სახელმწიფო საკუთრებაში არსებული უძრავი ქონების უსასყიდლო უზუფრუქტის უფლებით გადაცემაზე თანხმობის მიცემის შესახებ

1. „სახელმწიფო ქონების შესახებ“ საქართველოს კანონის 36-ე მუხლის მე-2 პუნქტის შესაბამისად, მიეცეს თანხმობა საქართველოს ეკონომიკისა და მდგრადი განვითარების სამინისტროს სისტემაში შემავალ სსიპ - სახელმწიფო ქონების ეროვნულ სააგენტოს, ა(ა)იპ - ერთად რეალური ცვლილებებისათვის (ს/კ: №401981931) უსასყიდლო უზუფრუქტის უფლებით, შესაბამისი ხელშეკრულების გაფორმებიდან 20 (ოცი) წლის ვადით, სარგებლობაში გადასცეს ქ. ბორჯომში, დ. აღმაშენებლის ქ. №31-ში, პირველ სართულზე მდებარე 567.09 კვ.მ ფართი და მასზე წილობრივად დამაგრებული მიწის ნაკვეთი (მიწის (უძრავი ქონების) საკადასტრო კოდი: №64.23.02.605.01.528).

2. ამ განკარგულების პირველი პუნქტით გათვალისწინებული უძრავი ქონების უსასყიდლო უზუფრუქტის უფლებით გადაცემის პირობებზე განისაზღვროს, პირადად ან/და მესამე პირ(ებ)ის მეშვეობით:

ა) საქართველოს შრომის, ჯანმრთელობისა და სოციალური დაცვის სამინისტროს მიერ დადგენილი სტანდარტების შესაბამისად, ამ

საქართველოს მთავრობის განკარგულება  
№ 2954/01  
24.03.17

**ANNEX 2: CONTRACT OF PROPERTY TRANSFER BETWEEN NASP AND TRC**

**უსასყიდლო უზუფრუქტის ხელშეკრულება**

საქართველო, ქ. თბილისი,

11 მაისი, 2017 წელი

სსიპ - სახელმწიფო ქონების ეროვნული ააგენტო (შემდგენი, „მესაკუთრე“), წარმადგენელი სააგენტოს იურიდიული დეპარტამენტის სამართლებრივი უზრუნველყოფის სამსახურის ეურიდიული მრჩეველის მარიამ სახაძის (პირადი №01008047481) სახით, მოქმედი სსიპ - სახელმწიფო ქონების ეროვნული სააგენტოს თავმჯდომარის მიერ, 20.7 წლის 03 აპრილს გაცემული: №4/5882 მიწდომიდაცვის მინიჭებული უფლებამოსილების საფუძველზე და ფარგლებში,

ასიპ „ერთად რეალური ცვლილებებისათვის“ (ს/რ 401981931) (შემდგენი, „უზუფრუქტუარი“), წარმოდგენილი გამგეობის თავმჯდომარის, ნანა ლომაძის (პირადი №62001009921) სახით,

ერთობლივად წოდებული, როგორც „მხარეები“ და ცალკადაც, როგორც „მხარე“,

ვხელმძღვანელობთ რა, საქართველოს სამოქალაქო კოდექსით, „სახელმწიფო ქონების შენახვებ“ საქართველოს ვანაჩიი, და ასიპ - ერთად რეალური ცვლილებებისათვის სახელმწიფო საკუთრებაში არსებული უძრავი ქონების უსასყიდლო უზუფრუქტის უფლებით გადაცემის თაობაზე თანხმობის წიგნის შენახვებ“ საქართველოს მთავრობის 2017 წლის 23 მარტის №558 განკარგულებით, ცდებით წინამდებარე ხელშეკრულებას (შემდგენი, „ხელშეკრულება“):

**მუხლი 1. ხელშეკრულების საგანი**

1.1 „მესაკუთრე“ გადასცემს, ხოლო „უზუფრუქტუარი“ უსასყიდლო უზუფრუქტის უფლებით იცემს სახელმწიფო საკუთრებაში არსებულ, ქ. ზორჯომში, დ. აღმაშენებლის ქ. №31-ში, პირველ სართულზე მდებარე 567.09 კვ.მ ფართს და მასზე წილობრივად დამატრებულ მიწის ნაკვეთს (მიწის უძრავი ქონების) საკადასტრო კოდი №64.23.02.605.01.528) (შემდგენი, „ქონება“).

1.2 „ხელშეკრულება“ მოქმედებს „ხელშეკრულების“ გაყონწყობიდან 20 (ოცი) წლის ვადით.

**მუხლი 2. მხარეთა უფლება-მოვალეობანი**

2.1 „უზუფრუქტუარი“ ვალდებულია:

2.1.1 პირადად ან/და მესამე პირების მეშვეობით, საქართველოს შრომის, ჯანმრთელობისა და სოციალური დაცვის სამინისტროს მიერ დადგენილი სტანდარტების შესაბამისად უზრუნველყოს „ქონებაში“ ეროდროულად არანაკლებ 40 (ორმოცი) ადამიანის მომსახურებაზე ვაოცლილი შეზღუდული შესაძლებლობის მქონე პირებისათვის დღის ცენტრის შექმნა (რაც მოიცავს (მაგრამ შესაძლოა, არ შენითგარგლებოდეც) ქონების სარეკონსტრუქციო ან/და სარემონტო სამუშაოების გასორციელებას, აღჭურვა, პერსონალის გადარზადებას) და ფუნქციონირების დაწყება „ხელშეკრულების“ გაფორნებიდან 7 (შვიდი) ივის ვადაში.

### ANNEX 3: RECONSTRUCTION PLAN OF THE BUILDING

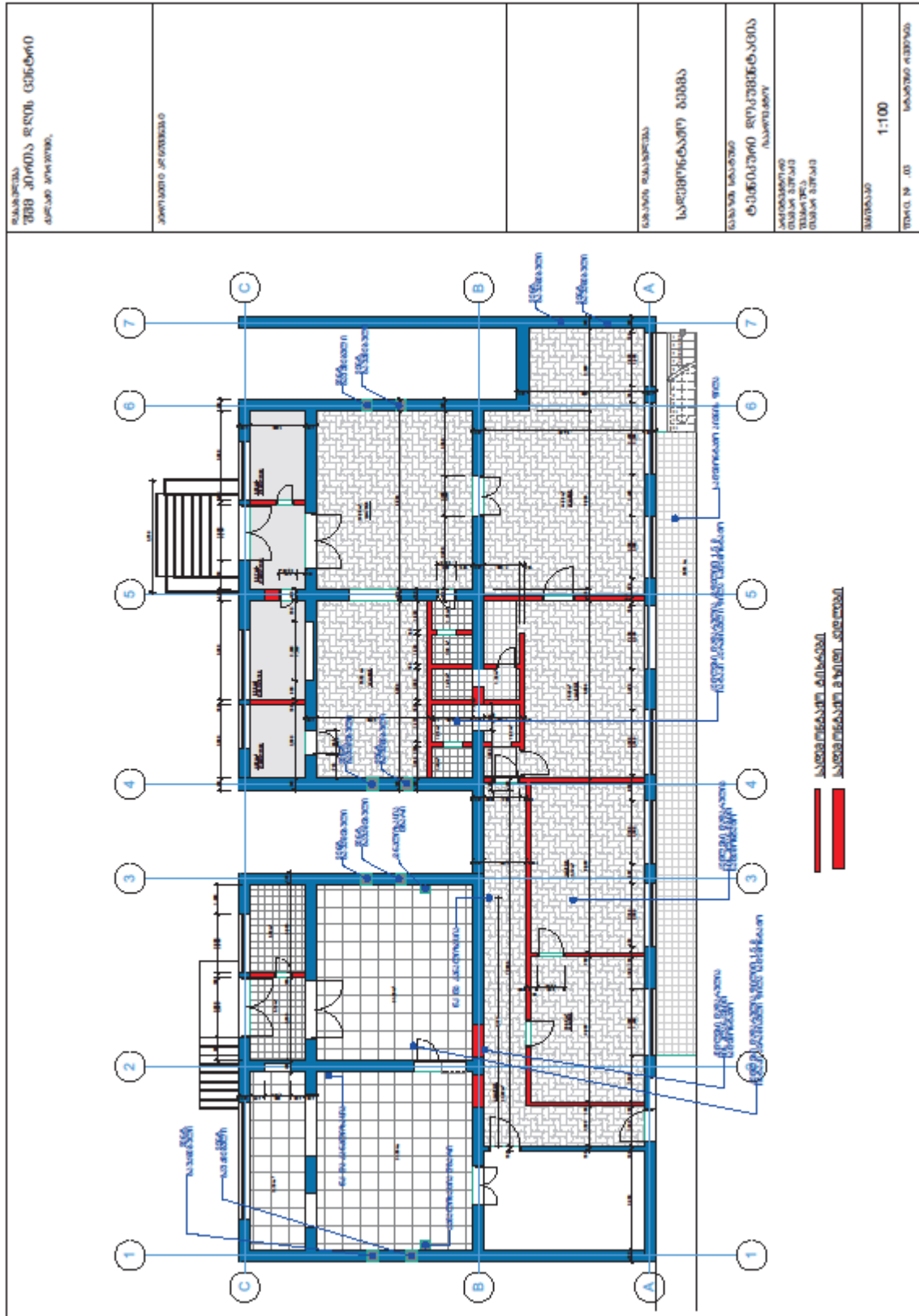

KUNNAN KUNNALLINEN 2008 ADONIN KUNNAN KUNNALLINEN KUNNAN KUNNALLINEN	KUNNAN KUNNALLINEN
KUNNAN KUNNALLINEN KUNNAN KUNNALLINEN	KUNNAN KUNNALLINEN
KUNNAN KUNNALLINEN KUNNAN KUNNALLINEN	KUNNAN KUNNALLINEN
KUNNAN KUNNALLINEN KUNNAN KUNNALLINEN	KUNNAN KUNNALLINEN
KUNNAN KUNNALLINEN KUNNAN KUNNALLINEN	KUNNAN KUNNALLINEN
KUNNAN KUNNALLINEN KUNNAN KUNNALLINEN	KUNNAN KUNNALLINEN

## ANNEX 4: TRAINING CURRICULUM

Training of day care center personnel	N of days
<p><b>Module 1. Day center standards and practices</b></p> <ul style="list-style-type: none"> <li>❖ National Standard for Day Care Center Service for persons with disabilities</li> <li>❖ Regulations and laws related to National Standard for Day Care Center Service</li> <li>❖ Required documentations related to National Standard for Day Care Center Service and their provision</li> <li>❖ The aim and the function of the Day Care Center</li> <li>❖ The main principles of Day Care Center management and operation (staff; multidisciplinary approach; individual centered, family centered, etc.)</li> <li>❖ Day Care Center program, schedule, daily routine</li> <li>❖ Portfolio of a child</li> <li>❖ Main organizational principles and approaches (group formation; group allocation; group and individual work; balancing group and individual work)</li> <li>❖ Parents involvement and consultation</li> <li>❖ Day Care Center and partnering with other services - schools; re-/habilitation programs</li> <li>❖ Referral</li> <li>❖ Searching for resources and support</li> <li>❖ Assessment of Day Care Center work performance and effectiveness</li> <li>❖ Hygiene and infection prevention</li> <li>❖ Center management and budgeting</li> <li>❖ Checks and balances/monitoring</li> </ul>	<b>3 days</b>
<p><b>Module 2. Understanding Disabilities</b></p> <ul style="list-style-type: none"> <li>❖ Identity to job performance and description (discussing and analyzing own and others job descriptions)</li> <li>❖ Sharing of responsibilities; main principles of multidisciplinary team approach</li> <li>❖ Understanding of disabilities/special needs</li> <li>❖ Developmental norms and spheres</li> <li>❖ Developmental disorders</li> </ul>	<b>4 days</b>
<p><b>Module 3. Assessment</b></p> <ul style="list-style-type: none"> <li>❖ The meaning and importance of assessment procedure</li> <li>❖ Assessment spheres <ul style="list-style-type: none"> <li>- Independent living skills – ADL, functional skills</li> <li>- Pre-academic and academic skills</li> <li>- Cognitive skills</li> <li>- Speech and Communication</li> <li>- Motor skills</li> </ul> </li> <li>❖ Assessment Methods and sources</li> <li>❖ Assessment instruments</li> <li>❖ Description and documentation of assessment results</li> <li>❖ Assessment using multidisciplinary team approach, sharing of responsibilities and roles</li> </ul>	<b>5 days</b>
<p><b>Module 4. Behaviour management strategies</b></p> <ul style="list-style-type: none"> <li>❖ Reasons and aim of challenging behavior</li> <li>❖ Assessment of challenging behavior</li> <li>❖ ABC Model</li> <li>❖ Positive Reinforcement</li> <li>❖ Tantrum</li> </ul>	<b>3 days</b>
<p><b>Module 5. Intervention and Teaching strategies</b></p> <ul style="list-style-type: none"> <li>❖ Main principals of interventions</li> <li>❖ Importance of Play and participation in activities</li> <li>❖ The main strategies for ADL development <ul style="list-style-type: none"> <li>- Positioning, Mobility, Self-care (Dressing, Feeding/Eating, Toileting, Washing, Hygiene, ect.)</li> </ul> </li> <li>❖ The main strategies for pre-academic and academic skills development</li> <li>❖ The main strategies for cognitive development</li> <li>❖ The main strategies for speech and communication development</li> <li>❖ The main strategies for motor development</li> <li>❖ Preparation for independent living and transition to the next stage <ul style="list-style-type: none"> <li>- Making choice; organizational skills, time management, etc.</li> </ul> </li> </ul>	<b>6 days</b>

- Vocational orientation	
<b>Module 6. Planning intervention and providing intervention</b> ❖ Main principles for creating individual re-/habilitation plan ❖ Integration of individual plan into the Day Care Center Program (Curriculum); Importance, Challenges, Possibilities) ❖ Working on individual plan in groups and individually – Factors to consider ❖ Individual re-/habilitation goals – selection and formation; ❖ Individual re-/habilitation activities – selection, adaptation, creation ❖ Organizing activities <ul style="list-style-type: none"> <li>- Selection, adaptation, creation of materials/recourses</li> <li>- Organizing space</li> <li>- Formation and provision of instructions</li> <li>- Defining and providing right level of support</li> <li>- Other factors to consider</li> </ul> ❖ Documenting Individual re-/habilitation plan ❖ Parents involvement/participation ❖ Consulting parents	<b>4 days</b>
<b>Module 7. Sensory Integration</b> ❖ Introduction to Sensory Integration ❖ Discussing Sensory System ❖ Sensory integration and different developmental disorders ❖ Play and sensory integration ❖ Creating and using sensory toys	<b>2 days</b>
<b>Module 8. Accessible Environmental</b> ❖ Environment Standards ❖ Universal adaptations ❖ Organizing, adapting environment ❖ Using adaptive equipment for mobility/play/classroom ❖ Positioning ❖ Mobility/transfers	<b>2 days</b>
<b>On-the-Job Supervision</b> ❖ On site management monitoring and feedback ❖ On site IEP development and implementation ❖ On site independent living skills training ❖ On site handling and sensory integration training ❖ On site play and exercise instruction	<b>7 days</b>
	<b>7 days</b>
	<b>7 days</b>